

Precision Steel

precidur[®] C22 / C22E

Product information for hot-rolled precision strip made in Hohenlimburg



thyssenkrupp

Version 01/22

Heat treatable and spring steel

Whether it's for wear parts, springs, chain links or safety components, heat treatable steels from BU Precision Steel offer the right solution for all requirements. Good fine blanking properties and formability in the annealed condition are combined with high strengths and good toughness in the quenched and tempered condition. Close analysis ranges tailored to specific purposes and precisely controlled rolling parameters guarantee consistent and outstanding processability and consistent heat treatment results.

We can supply a variant of unalloyed and alloyed heat treatable steels in accordance with DIN EN ISO 683, resp. DIN EN 10083 with carbon contents between 0.20 % and 0.60 %, and spring steels analogous to DIN EN 10132.

precidur[®]

- is used in virtually all industry sectors.
- offers close thickness tolerances similar to cold-rolled strip, optimum surface finishes and consistent material properties over the entire strip length and width.
- is characterized by its symmetrical strip profiles and mill edges.
- is the sum of all the experience we have gained in more than 100 years of manufacturing and processing steel.

Contents

Brief portrait
Technical features
Chemical composition
Mechanical properties
General thickness tolerances
Delivery options
Application examples

Technical features

Heat treatable steel

Material number: 1.0402 / 1.1151

Material name: C22 / C22E

Proprietary brand: precidur® C22 / C22E

Delivery specification: DIN EN 10083-2 and based on DIN EN 10132

Application: Heat-treatable steel for parts in auto and machinery construction

Chemical composition

Ladle analysis mass percentages	C [%]	Si [%]	Mn [%]	P [%]	S [%]	Cr [%]	Mo [%]	Ni [%]	Al [%]	Cu [%]
min.	0.17	0.10	0.40	-	-	-	-	-	-	-
max.	0.24	0.40*	0.70	0.025	0.015	0.30**	0.10	0.20	0.015*	0.20

Further special analyses available

* Si and Al variants available

** Cr-free variant available

Mechanical properties

Longitudinal to rolling direction	Tensile strength R _m [MPa]	Elongation A ₅ [%]
Rolled condition	Ø 500	min. 22
GKZ annealed	max. 520	min. 24

Possible delivery options

Options	Mill edge (NK) Cut edge (GK)	pickled		unpickled	slit	trimmed	Cut to length	annealed	not annealed
		✓	or	✓	✓	✓	✓	✓	✓
precidur® C22/C22E	NK or GK	✓	or	✓	✓	✓	✓	✓	✓

General thickness tolerances

Strip thickness [mm]	1.5 – 2.54	2.55 – 4.03	4.04 – 6.03	6.04 – 8.03	8.04 – 9.03	9.04 – 11.03	11.04 – 14.03	14.04 – 16.00
Standard tolerances [mm]	± 0.04	± 0.04	± 0.05	± 0.055	± 0.06	± 0.07	± 0.08	± 0.10
Special tolerances [mm]	± 0.03	± 0.035	± 0.04	± 0.045	± 0.05	± 0.055	± 0.06	± 0.07

General delivery options

Coil inner diameter: standard 508 mm / optional 610 mm

Coil outer diameter: max. 1,890 mm

Coil weight: max. 20.5 kg/mm strip width

Strip width*: max. 720 mm

Strip thickness*: 1.5 – 16 mm

* May be subjected to restrictions.

Application examples for heat treatable and spring steel

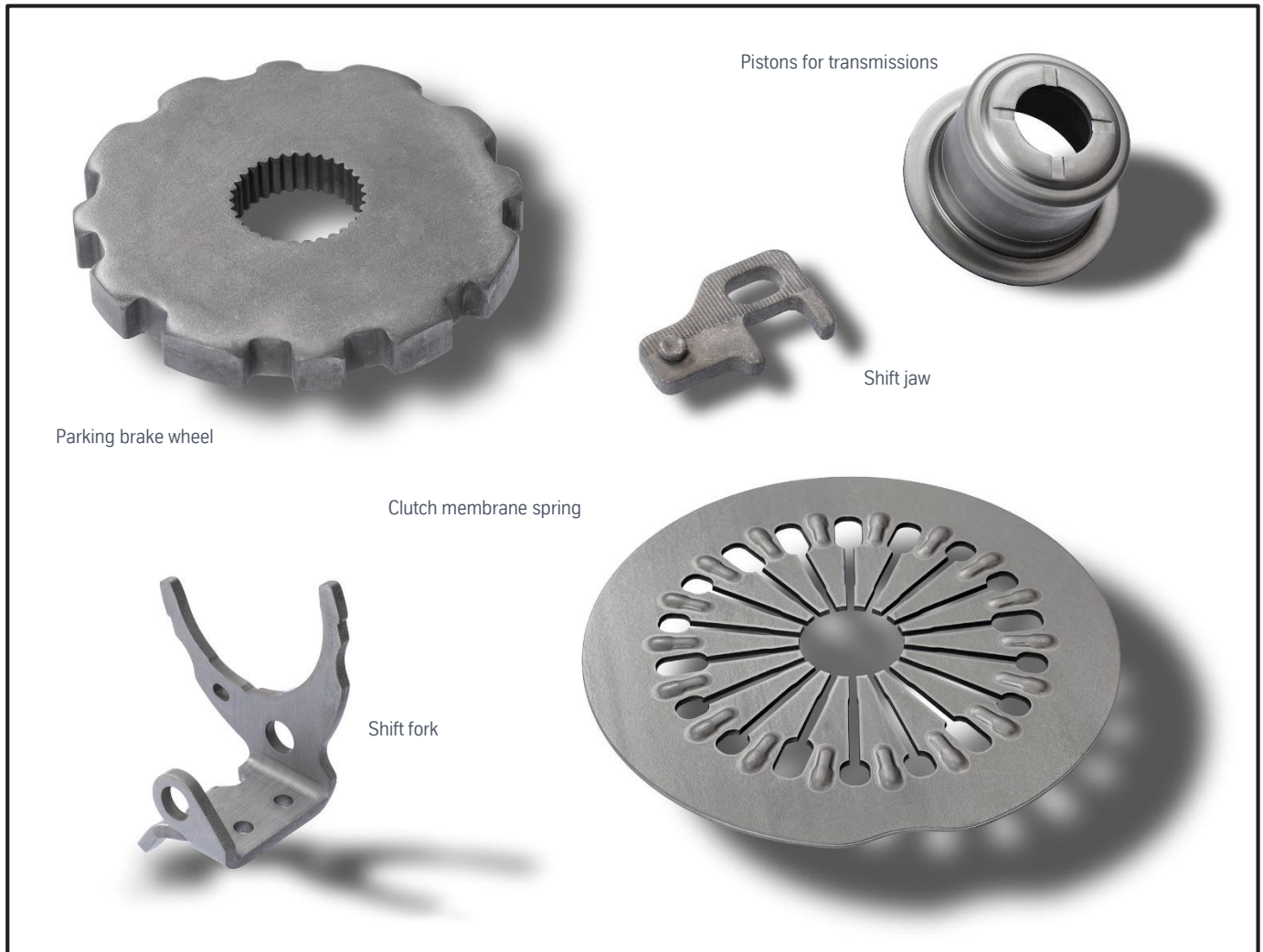

Special mill grades feature unique thyssenkrupp properties. Other terms and conditions of supply not specified here will be based on the applicable specifications. The specifications used will be those valid on the date of publication of this product information.

General information:

All statements as to the properties or utilization of material and products are for the purpose of description only. Guarantees in respect of the existence of certain properties or utilization are only valid if agreed in writing. Subject to technical changes. Reprints, in whole or in part, only with the permission of thyssenkrupp Hohenlimburg GmbH. The latest version of this product information can be found at: <https://www.thyssenkrupp-steel.com/en/publications/>

Please contact our sales/technical customer support team for detailed information.

thyssenkrupp Hohenlimburg GmbH, Oeger Str. 120, 58119 Hagen
 T: +49 2334 91 2555
www.thyssenkrupp-steel.com, info.precisionsteel@thyssenkrupp.com